

**SPRING LAKE (SHEET 2)  
AQUATIC PLANT SURVEY MAP  
MUSKEGON AND OTTAWA COUNTIES**

□ = 1 ACRE

LAKE AREA: 1,091 ACRES  
REVISION DATE: FEBRUARY, 2022

Date: \_\_\_\_\_  
Crew: \_\_\_\_\_  
Weather: \_\_\_\_\_  
Notes: \_\_\_\_\_

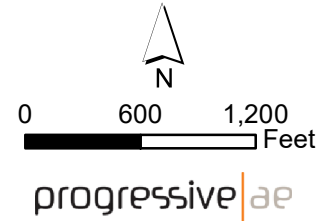
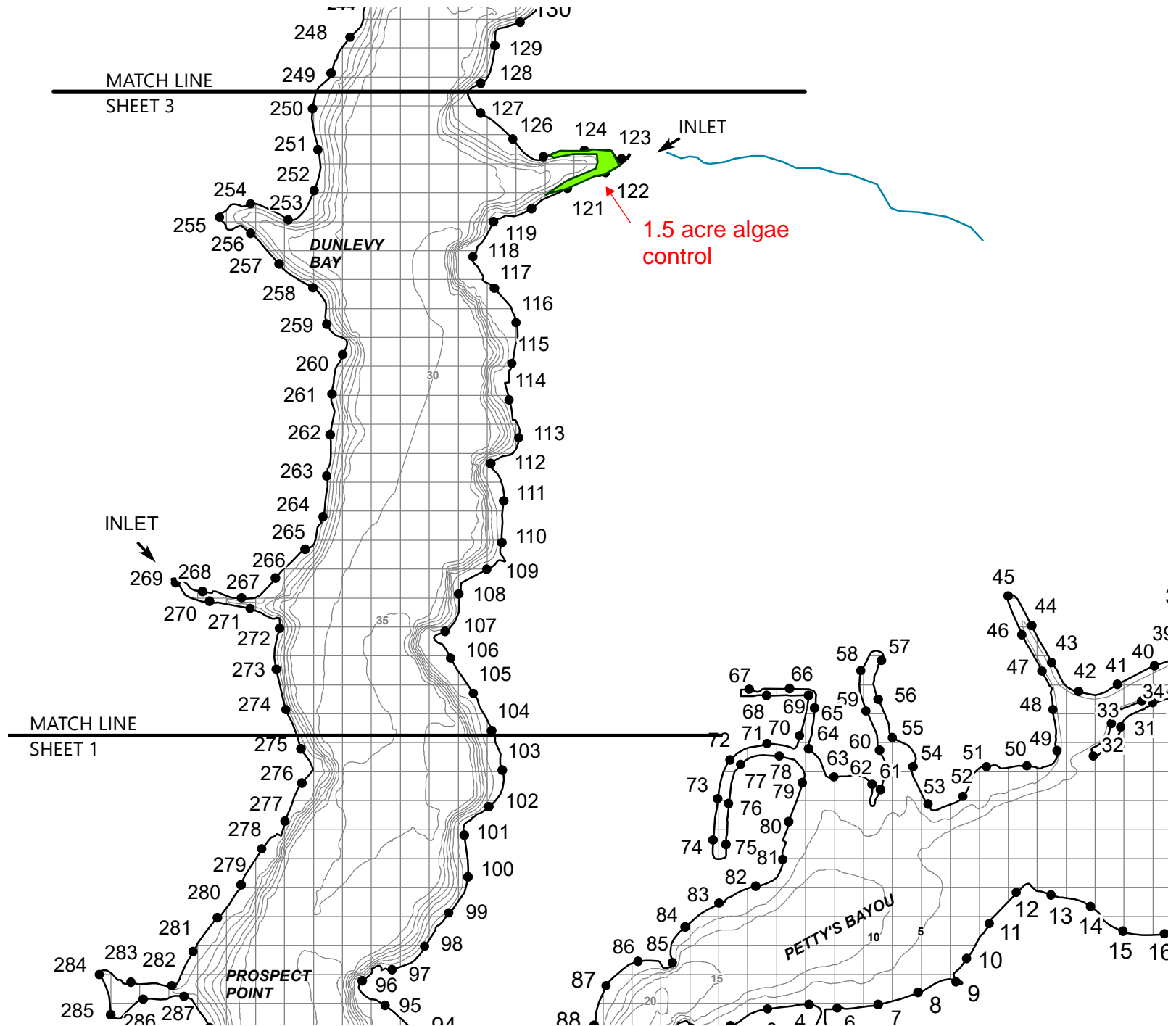

# SPRING LAKE (SHEET 4) AQUATIC PLANT SURVEY MAP MUSKEGON AND OTTAWA COUNTIES

□ = 1 ACRE

Date: \_\_\_\_\_

Crew: \_\_\_\_\_

Weather: \_\_\_\_\_

Notes:

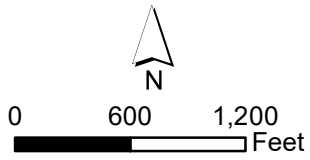
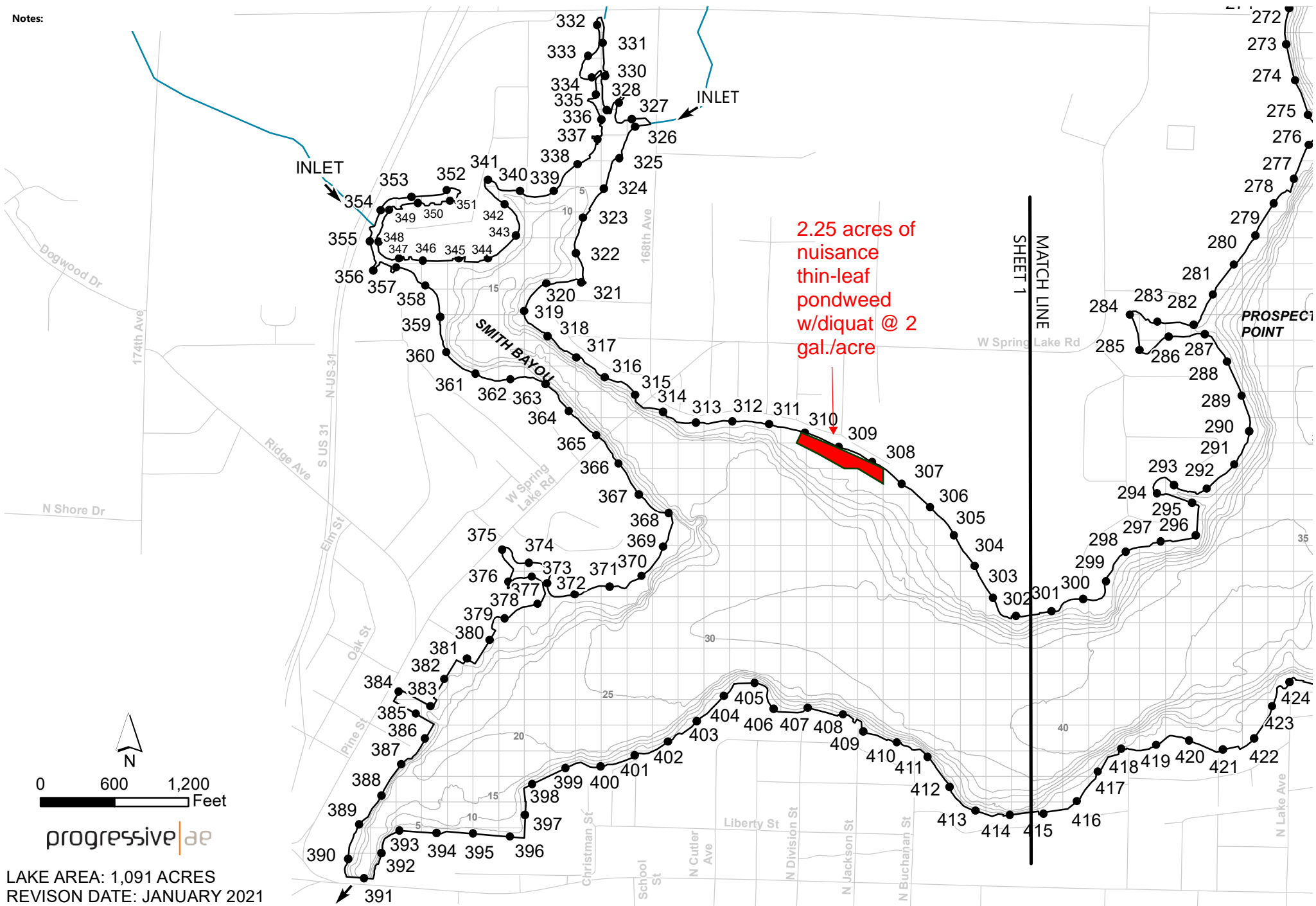

progressive|ae

LAKE AREA: 1,091 ACRES  
REVISION DATE: JANUARY 2021