

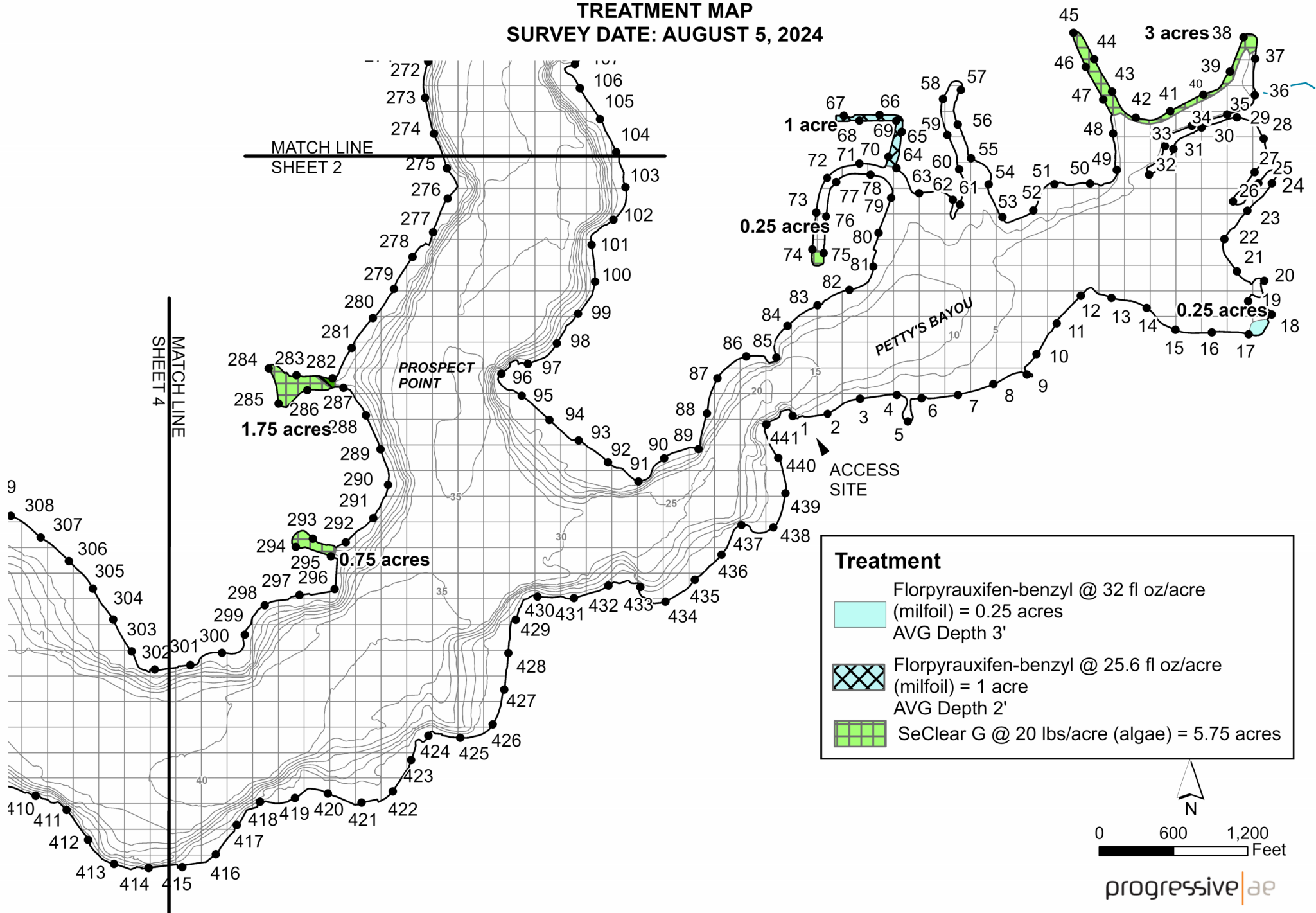



**SPRING LAKE (SHEET 1)  
MUSKEGON AND OTTAWA COUNTIES  
TREATMENT MAP  
SURVEY DATE: AUGUST 5, 2024**

□ = 1 ACRE



**Treatment**

-  Florpyrauxifen-benzyl @ 32 fl oz/acre (milfoil) = 0.25 acres  
AVG Depth 3'
-  Florpyrauxifen-benzyl @ 25.6 fl oz/acre (milfoil) = 1 acre  
AVG Depth 2'
-  SeClear G @ 20 lbs/acre (algae) = 5.75 acres

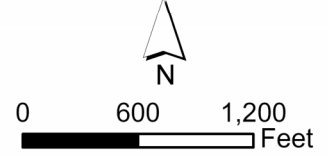

progressive|ae

LAKE AREA: 1,091 ACRES  
REVISION DATE: FEBRUARY 2022

The applicator shall make adjustments, if needed, to comply with EGLE permit requirements.

The applicator shall make adjustments, if needed, to comply with EGLE permit requirements.

□ = 1 ACRE

# SPRING LAKE (SHEET 2) MUSKEGON AND OTTAWA COUNTIES TREATMENT MAP SURVEY DATE: AUGUST 5, 2024

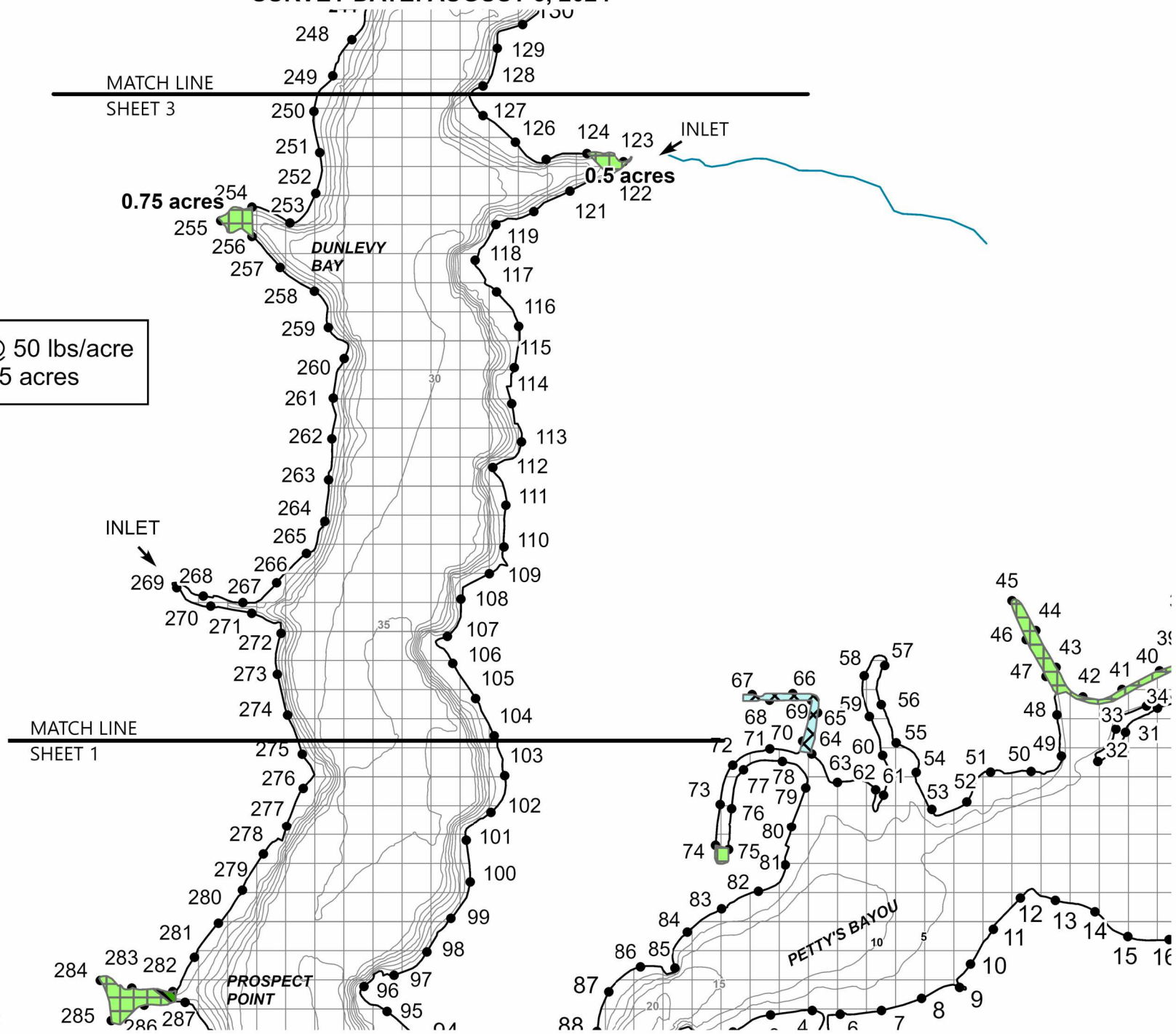

 SeClear G @ 50 lbs/acre  
(algae) = 1.25 acres

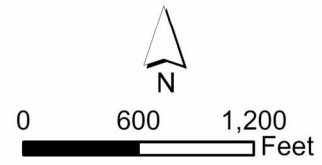

progressive|ae  
LAKE AREA: 1,091 ACRES  
REVISION DATE: FEBRUARY 2022

□ = 1 ACRE

# SPRING LAKE (SHEET 3) MUSKEGON AND OTTAWA COUNTIES TREATMENT MAP SURVEY DATE: AUGUST 5, 2024

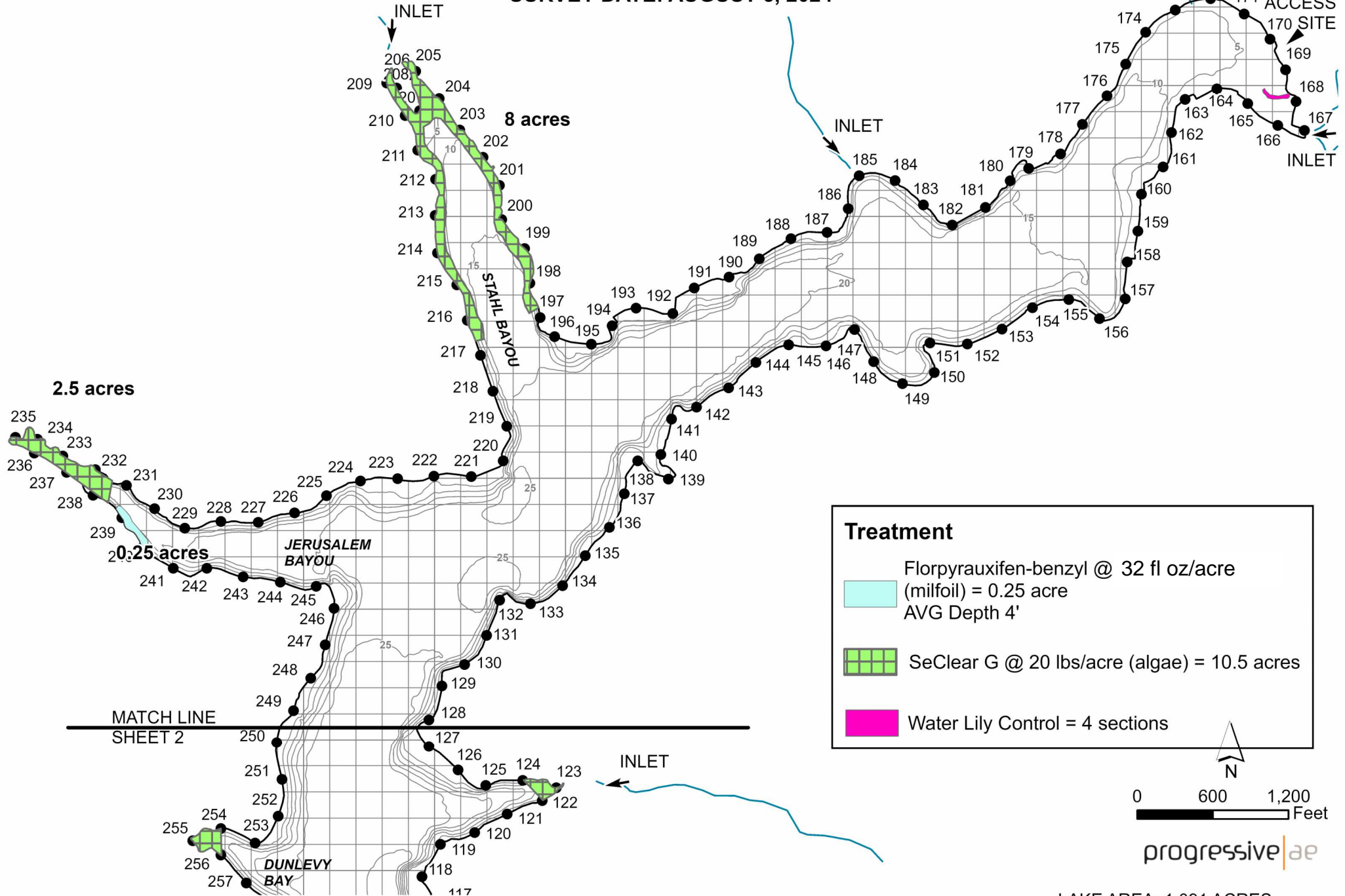

**Treatment**

- Florpyrauxifen-benzyl @ 32 fl oz/acre (milfoil) = 0.25 acre  
AVG Depth 4'
- SeClear G @ 20 lbs/acre (algae) = 10.5 acres
- Water Lily Control = 4 sections

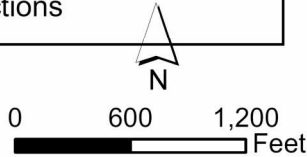

progressive|ae

LAKE AREA: 1,091 ACRES  
REVISION DATE: FEBRUARY 2022

The applicator shall make adjustments, if needed, to comply with EGLE permit requirements.

The applicator shall make adjustments, if needed, to comply with EGLE permit requirements.

# SPRING LAKE (SHEET 4) MUSKEGON AND OTTAWA COUNTIES TREATMENT MAP SURVEY DATE: AUGUST 5, 2024

□ = 1 ACRE

