

**SPRING LAKE (SHEET 1)
TREATMENT MAP
MUSKEGON AND OTTAWA COUNTIES
SURVEY DATE: AUGUST 22ND, 2023**

□ = 1 ACRE

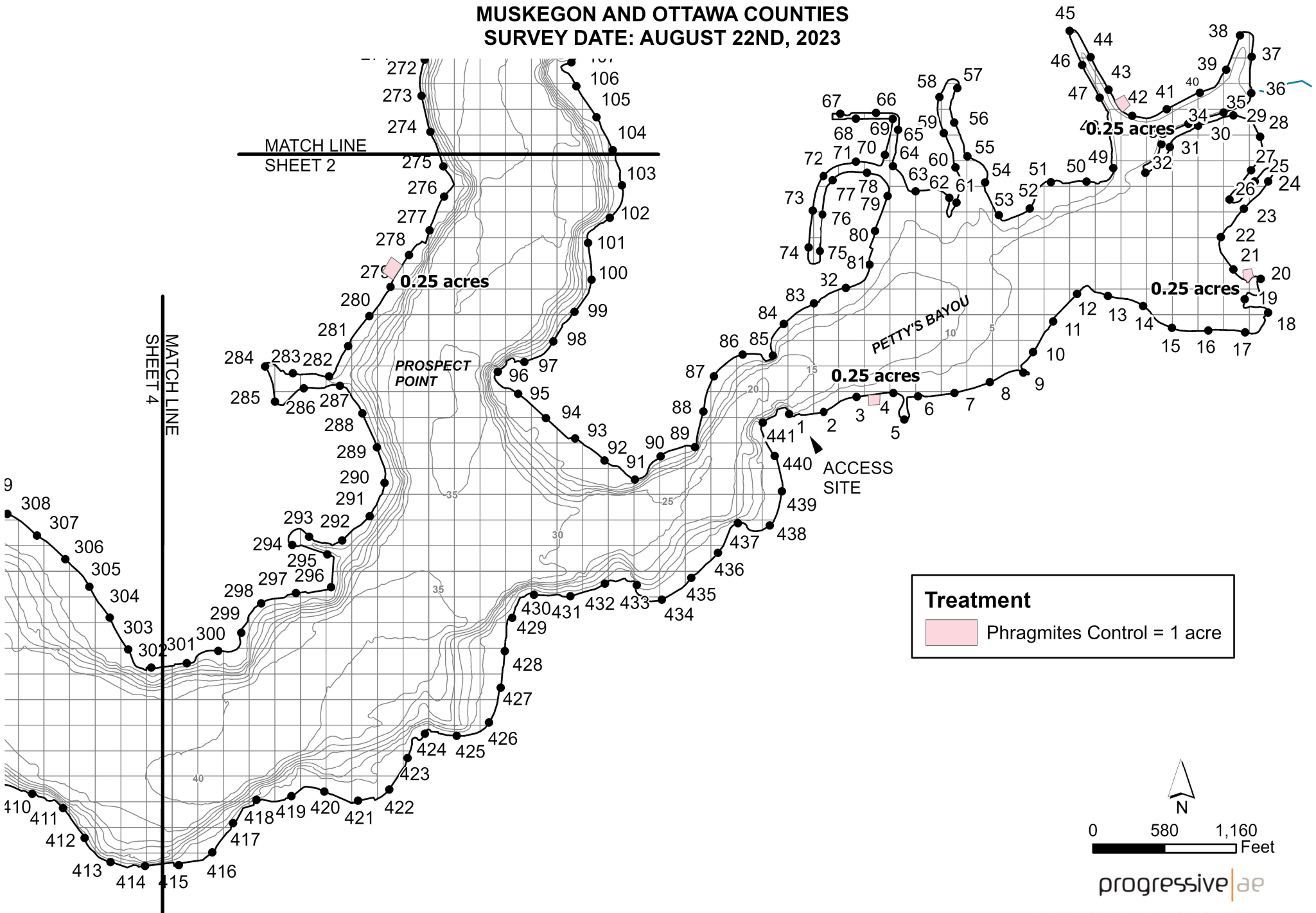

The applicator shall make adjustments, if needed, to comply with EGLE permit requirements.

LAKE AREA: 1,091 ACRES
REVISION DATE: FEBRUARY 2022

The applicator shall make adjustments, if needed, to comply with EGLE permit requirements.

□ = 1 ACRE

SPRING LAKE (SHEET 2) TREATMENT MAP MUSKEGON AND OTTAWA COUNTIES SURVEY DATE: AUGUST 22ND, 2023

Treatment

Phragmites Control = 1.25 acres

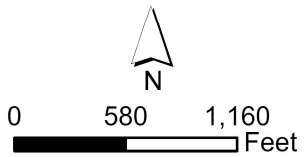
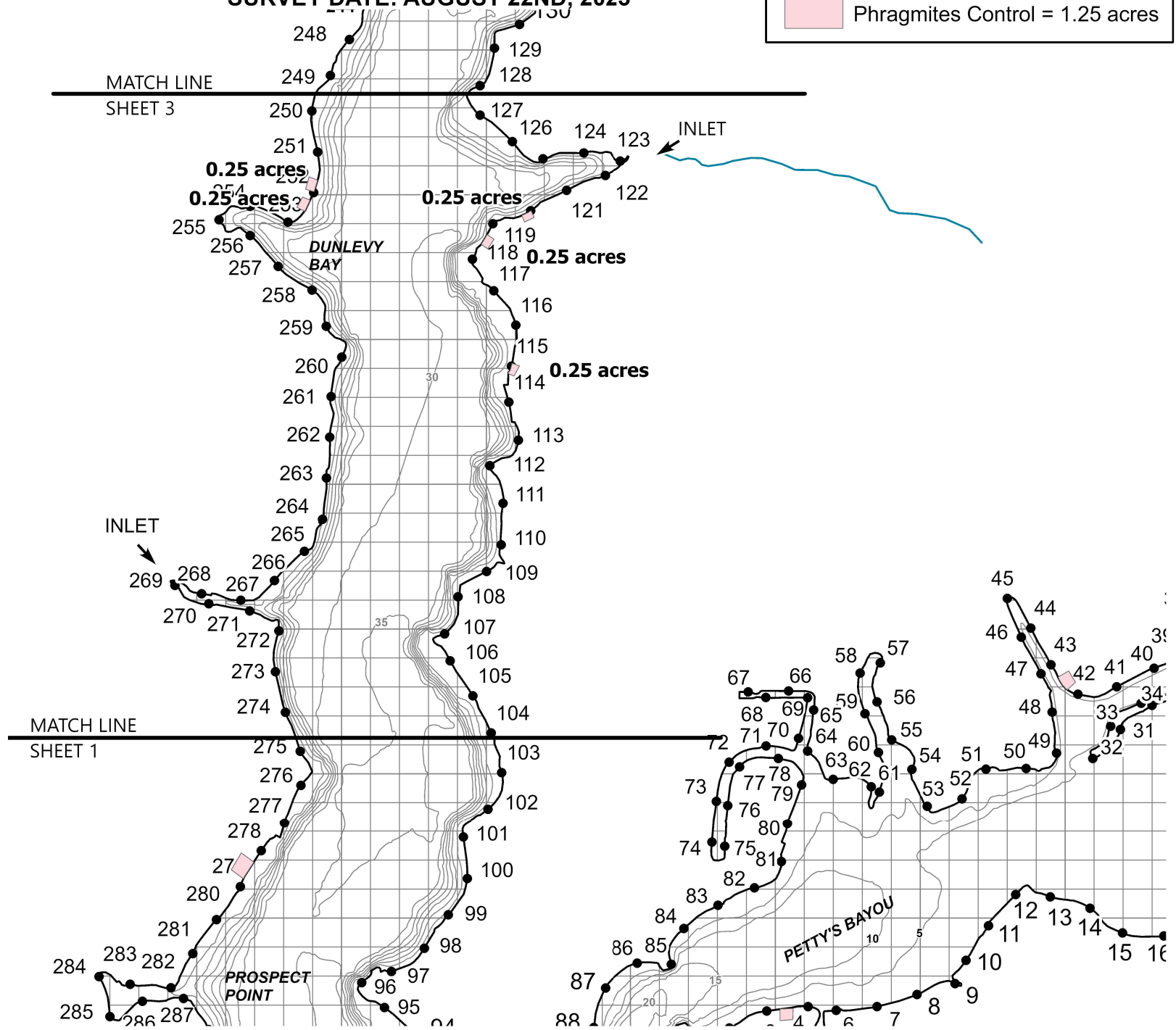

progressive|ae

LAKE AREA: 1,091 ACRES
REVISION DATE: FEBRUARY 2022

□ = 1 ACRE

SPRING LAKE (SHEET 3) TREATMENT MAP MUSKEGON AND OTTAWA COUNTIES SURVEY DATE: AUGUST 22ND, 2023

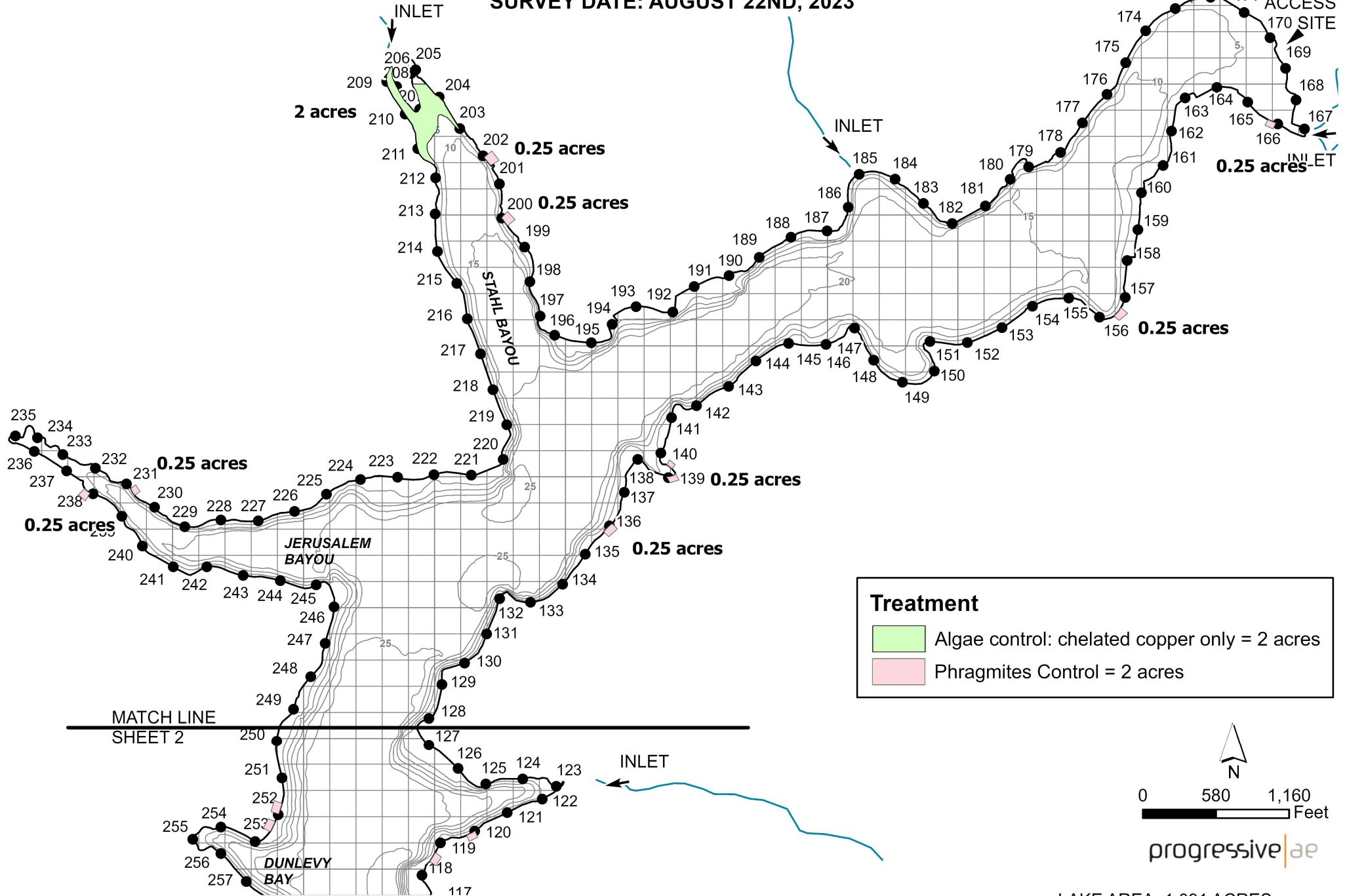

The applicator shall make adjustments, if needed, to comply with EGLE permit requirements.

LAKE AREA: 1,091 ACRES
REVISION DATE: FEBRUARY 2022

The applicator shall make adjustments, if needed, to comply with EGLE permit requirements.

SPRING LAKE (SHEET 4) TREATMENT MAP MUSKEGON AND OTTAWA COUNTIES SURVEY DATE: AUGUST 22ND, 2023

□ = 1 ACRE

Treatment

Phragmites Control = 1.25 acres

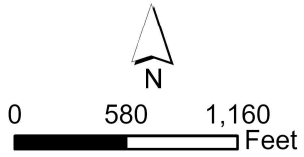
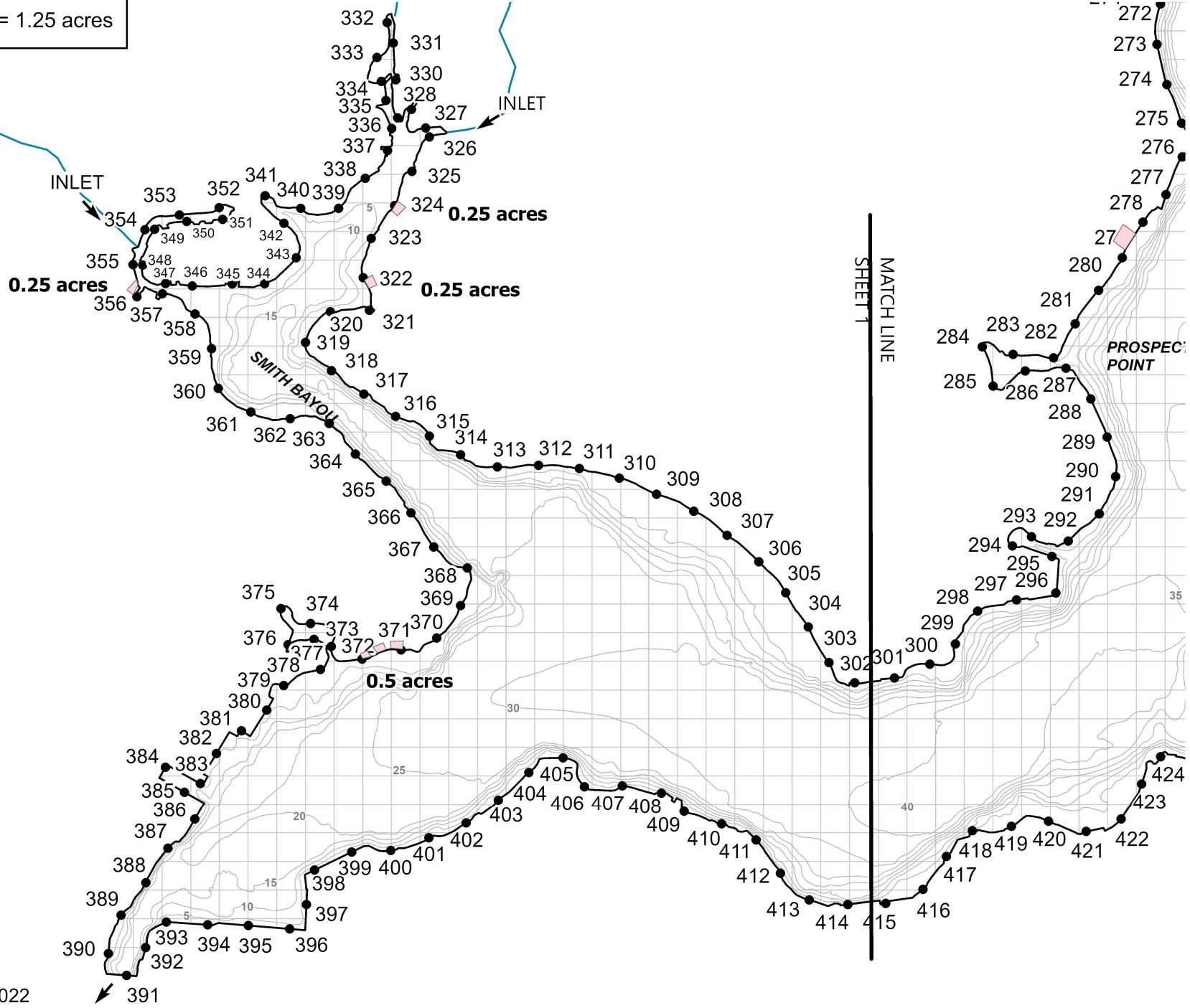

progressive|ae

LAKE AREA: 1,091 ACRES
REVISION DATE: FEBRUARY 2022